



Apartment (EPC Rating: C)

**SCAMMELL WAY, WATFORD, WD18**

**6GN**

Per Month

**£1,600 Per**

# 2 Bedroom Apartment located in Watford

TOP FLOOR TWO BEDROOM APARTMENT IN A SMALL BLOCK OF 3 PROPERTIES LOCATED ON SCAMMELL WAY - OPPOSITE WESTFIELD ACADEMY AND VERY CLOSE TO WATFORD GENERAL HOSPITAL - AVAILABLE NOW.

This bright and spacious top-floor two-bedroom apartment is perfectly situated for NHS professionals, just moments from Watford General Hospital and opposite Westfield Academy, an excellent local school.

Set within a small, exclusive block of only three flats, this rare property offers exceptional privacy. It's the only flat on the top floor and has its own private hallway. Inside, you'll find a large living room flooded with natural daylight, a well-proportioned kitchen, two comfortable bedrooms, and a modern bathroom.

The apartment comes with one allocated parking space and visitor parking for added convenience.

A lovely, light-filled home in a sought-after location — available now!



GROUND FLOOR  
554 sq.ft. (51.5 sq.m.) approx.

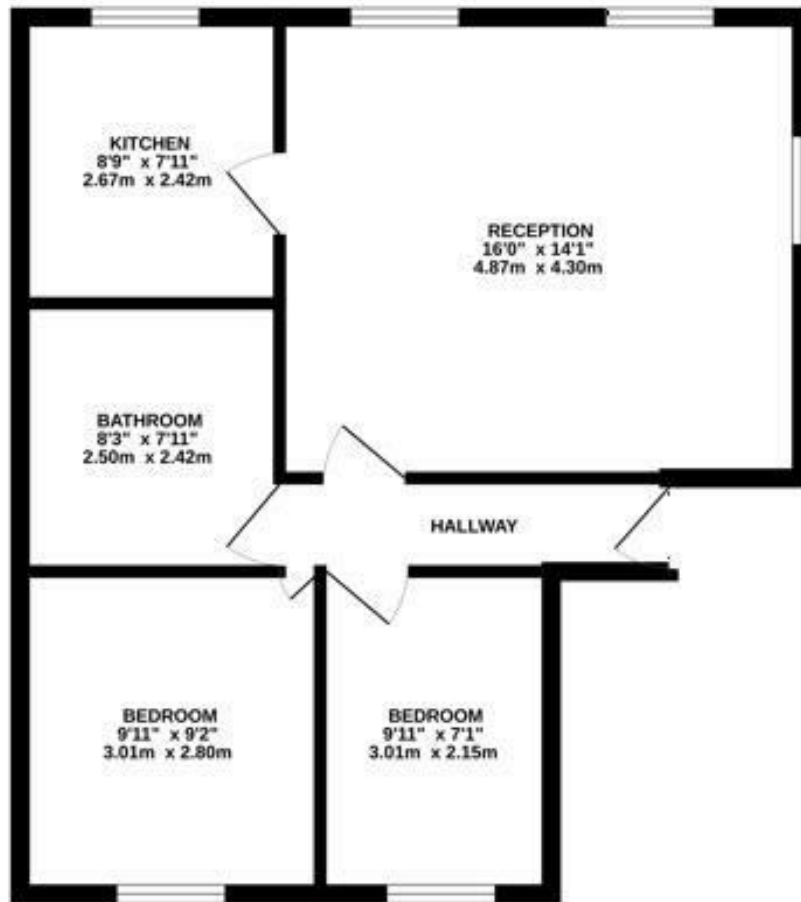

TOTAL FLOOR AREA: 554 sq.ft. (51.5 sq.m.) approx.

While every attempt has been made to ensure the accuracy of the figures contained here, measurements of doors, windows, rooms and any other items are approximate and no responsibility is taken for any error, omission or mis-statement. This plan is for illustrative purposes only and should be used as such by any prospective purchaser. The services, systems and appliances shown here are not tested and no guarantee as to their operability or efficiency can be given. Plans will illustrate 1/2000

Council Tax Band

C

Energy Performance Graph

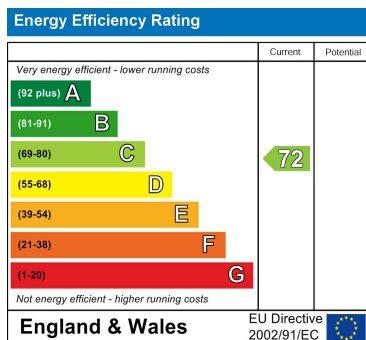

Call us on

01923 220 012

[enquiries@warrenanthony.co.uk](mailto:enquiries@warrenanthony.co.uk)

[www.warrenanthony.co.uk](http://www.warrenanthony.co.uk)

Agents Note: Whilst every care has been taken to prepare these particulars, they are for guidance purposes only. All measurements are approximate and are for general guidance purposes only and whilst every care has been taken to ensure their accuracy, they should not be relied upon and potential buyers are advised to recheck the