



Not specified (EPC Rating:)

COLNHURST ROAD, WATFORD, WD17
4BU

£350,000

null Bedroom Not specified located in Watford

A stunning 2 double bedroom apartment situated on the second floor and located a mere 83.3 metres from Nascot Wood Infant and Nuresery School

FULL DESCRIPTION

Located in the sought-after Nascot Grange development, this well-presented 2nd floor apartment offers modern living just a short walk from Watford Junction Station, providing fast links into London.

The property features two generous double bedrooms, a bright and airy living space, and a contemporary fitted kitchen with modern appliances. The stylish bathroom is finished to a high standard, adding to the home's appeal.

Families will appreciate the excellent location, with the highly regarded Nascot Wood School only 83.3 metres away. Residents also benefit from the peaceful, leafy surroundings of Nascot Grange while being moments from the amenities of Watford town centre.

This apartment is ideal for professionals, couples, or small families seeking comfort, convenience, and great transport links.



GROUND FLOOR
599 sq.ft. (55.7 sq.m.) approx.

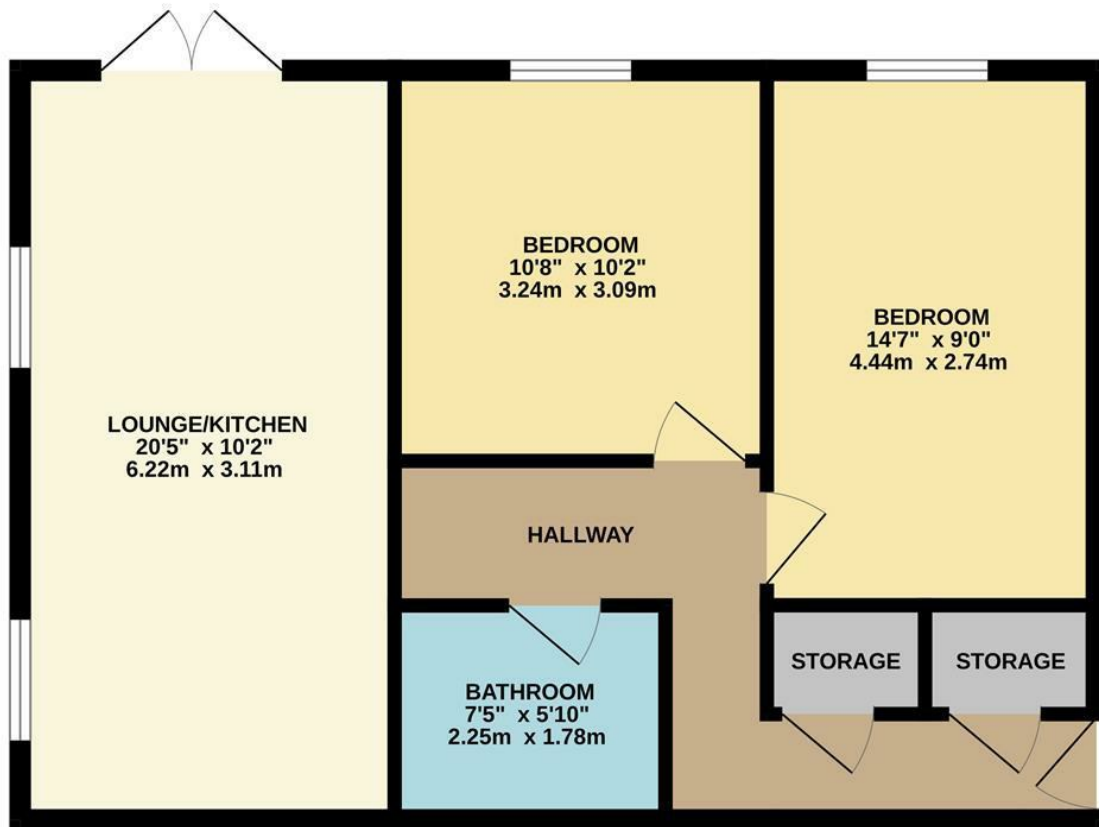

TOTAL FLOOR AREA : 599 sq.ft. (55.7 sq.m.) approx.
Whilst every attempt has been made to ensure the accuracy of the floorplan contained here, measurements of doors, windows, rooms and any other items are approximate and no responsibility is taken for any error, omission or mis-statement. This plan is for illustrative purposes only and should be used as such by any prospective purchaser. The services, systems and appliances shown have not been tested and no guarantee as to their operability or efficiency can be given.
Made with Metropix ©2025

Council Tax Band

Call us on

01923 220012

sales@warrenanthony.co.uk

<https://www.warrenanthony.co.uk>

Energy Performance Graph

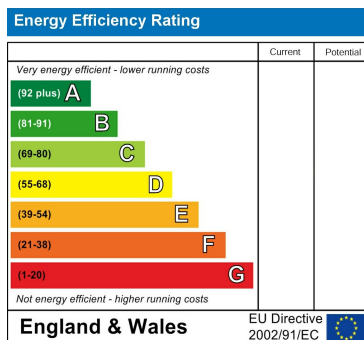

Agents Note: Whilst every care has been taken to prepare these particulars, they are for guidance purposes only. All measurements are approximate and are for general guidance purposes only and whilst every care has been taken to ensure their accuracy, they should not be relied upon and potential buyers are advised to recheck the