

26 East Street, Seaford, BN25 1AA
£367,500



Nestled in the charming coastal town of Seaford, this delightful end-terrace house on East Street offers a perfect blend of comfort and convenience. With two spacious reception rooms, this property provides ample space for both relaxation and entertaining. The inviting living areas are filled with natural light, creating a warm and welcoming atmosphere.

The house features two well-proportioned bedrooms, ideal for a small family or those seeking a peaceful retreat by the sea. The bathroom is thoughtfully designed, ensuring both functionality and comfort for everyday living.

One of the standout features of this property is the parking space available for two vehicles, a rare find in such a desirable location. This added convenience allows for easy access to the nearby amenities and the stunning coastline that Seaford has to offer.

Whether you are looking for a permanent residence or a holiday home, this property presents an excellent opportunity to enjoy the coastal lifestyle. With its charming character and practical layout, this end-terrace house is sure to appeal to a variety of buyers. Don't miss the chance to make this lovely home your own in the picturesque setting of Seaford.



87 Katherine Way
Seaford
East Sussex
BN25 2XF
01323 379500
hello@lukeharris.co.uk
www.lukeharris.co.uk

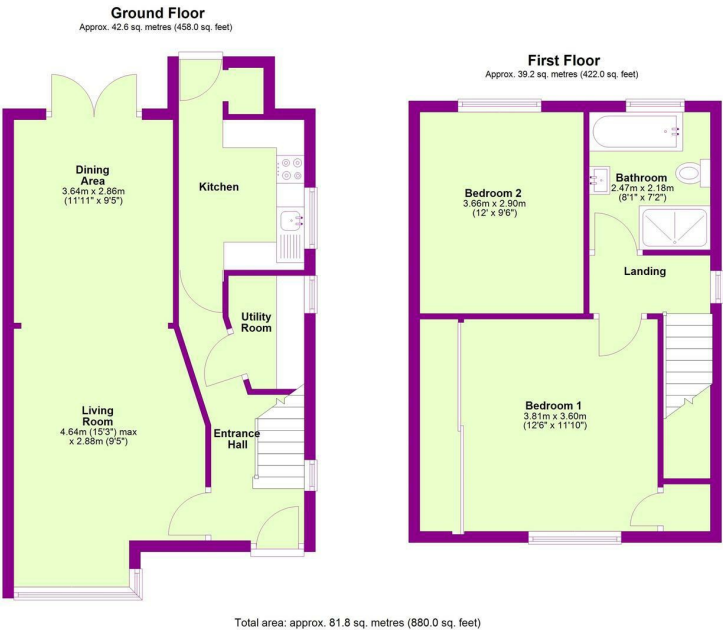
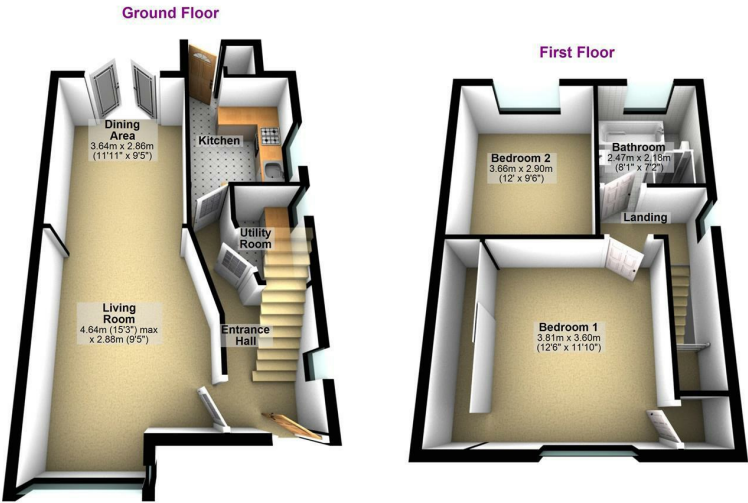

Energy Efficiency Rating			Environmental Impact (CO ₂) Rating		
	Current	Potential		Current	Potential
Very energy efficient - lower running costs			Very environmentally friendly - lower CO ₂ emissions		
(92 plus) A			(12 plus) A		
(81-91) B			(11-11) B		
(69-80) C			(10-10) C		
(55-68) D			(9-9) D		
(39-54) E			(8-8) E		
(21-38) F			(7-7) F		
(1-20) G			(6-6) G		
Not energy efficient - higher running costs			Not environmentally friendly - higher CO ₂ emissions		
England & Wales EU Directive 2002/91/EC			England & Wales EU Directive 2002/91/EC		