

3 Firle Court Chyngton Road, Seaford, BN25 4HD
£250,000



A truly splendid two double bedroom apartment, situated in a sought-after area. This stylish home is situated in a block of only four and has a bright and spacious feel together with neutral carpets and décor. Large living room, kitchen/dining room and a modern bathroom. The good size garage is accessed from an internal staircase. No Chain



87 Katherine Way
Seaford
East Sussex
BN25 2XF
01323 379500
hello@lukeharris.co.uk
www.lukeharris.co.uk

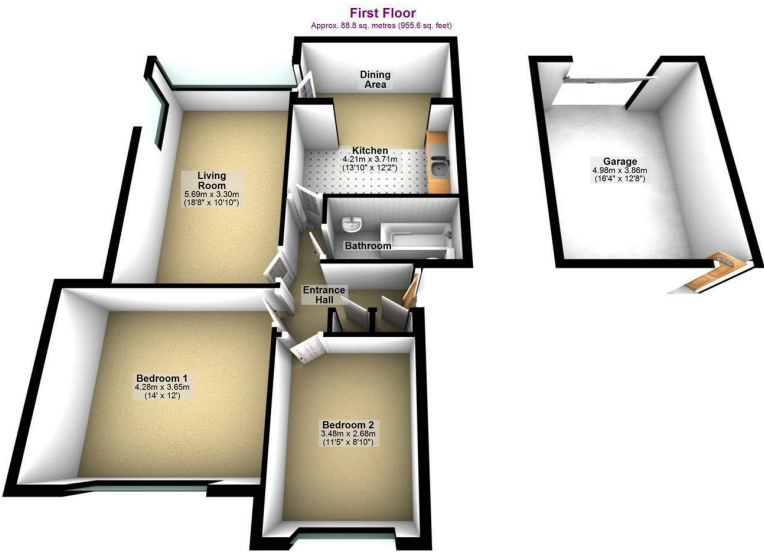

Total area: approx. 88.8 sq. metres (955.6 sq. feet)



Total area: approx. 88.8 sq. metres (955.6 sq. feet)

