

96 Barn Rise, Seaford, BN25 3DD
£1,375 PCM

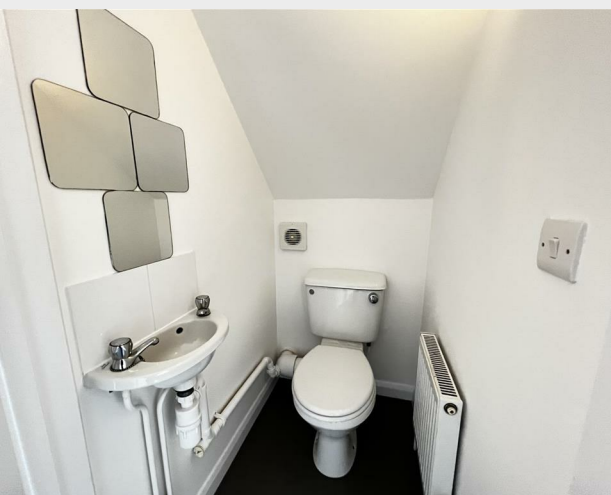

A modern 2 bedroom house in a popular area, close to buses to Brighton, Eastbourne and the town centre. Brand new carpets and re-decorated throughout. Modern fitted kitchen, white bathroom suite and UPVC double glazing, gas central heating, rear garden, off road parking to the front.



87 Katherine Way
 Seaford
 East Sussex
 BN25 2XF
 01323 379500
 hello@lukeharris.co.uk
 www.lukeharris.co.uk

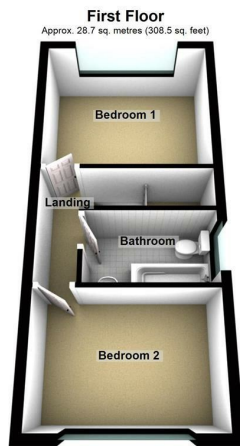
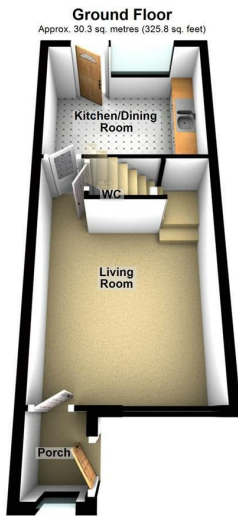

Total area: approx. 58.9 sq. metres (634.3 sq. feet)

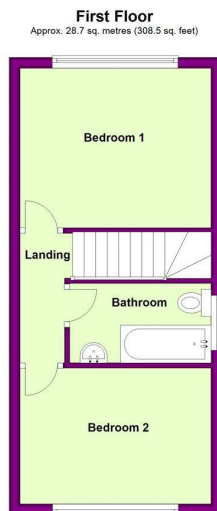

Total area: approx. 58.9 sq. metres (634.3 sq. feet)

Energy Efficiency Rating		Environmental Impact (CO ₂) Rating	
	Current	Potential	
Very energy efficient - lower running costs			Very environmentally friendly - lower CO ₂ emissions
(92 plus) A			(91-91) A
(81-91) B			(80-90) B
(69-80) C			(69-80) C
(55-68) D			(55-68) D
(39-54) E			(39-54) E
(21-38) F			(21-38) F
(1-20) G			(1-20) G
Not energy efficient - higher running costs			Not environmentally friendly - higher CO ₂ emissions
		76	
		90	
England & Wales	EU Directive 2002/91/EC		England & Wales
			EU Directive 2002/91/EC