



2 Somerset Close

Buxton, SK17 9XB

£265,000



2 Somerset Close

Buxton, SK17 9XB

Tenure Council Tax Band B



A very well presented three bedroom semi detached family home with the advantage of a substantial attached double garage/workshop. Benefitting from combi gas fired central heating and uPVC sealed unit double glazing throughout and generous conservatory to the rear. With superb well stocked garden to the rear. A viewing is highly recommended.

DIRECTIONS

From our Buxton office bear left up Terrace Road and up the Market Place. Proceed through the London Road traffic lights and continue along London Road and after a short while turn right in the dip and proceed up Harpur Hill Road. Turn first left into Berwick Road and follow this around, after a short while Somerset Close will be seen on the right hand side. No. 2 is immediately on the right.

GROUND FLOOR

Entrance Porch

7'10" x 7'5" (2.39m x 2.26m)

With tiled flooring throughout, single radiator, uPVC front entrance door and frosted uPVC sealed unit double glazed window to front. Door to garage. With space and plumbing for a washing machine and space for tumble dryer.

Hallway

10'9" x 2'1" (3.28m x 0.64m)

With single radiator and stairs to first floor.

Bedroom One

16'2" x 7'5" (4.93m x 2.26m)

With single radiator and uPVC sealed unit double glazed window to front.

Bedroom Two

12'2" x 7'7" (3.71m x 2.31m)

With a range of built in wardrobes and cupboards and shelving, single radiator and uPVC sealed unit double glazing double doors leading through into the conservatory.

Bedroom Three

8'8" x 7'11" (2.64m x 2.41m)

With single radiator and uPVC sealed unit double glazed window through to the conservatory.

Conservatory

12'11" x 9'7" (3.94m x 2.92m)

With double radiator, uPVC sealed unit double glazed throughout and with sliding uPVC doors leading out to the patio and garden beyond.

Bathroom

7'6" x 4'8" (2.29m x 1.42m)

Fitted with a good quality suite comprising of panelled bath with shower over and shower screen, low level W.C., and pedestal wash hand basin. With frosted uPVC sealed unit double glazed window to outside, stainless steel heated towel rail and fully tiled throughout.

FIRST FLOOR

Lounge

15'10" x 12'3" (4.83m x 3.73m)

With stripped wooden flooring throughout, a feature decorative wooden fireplace surround with coal effect electric fire, single radiator and uPVC sealed unit double glazed window to the rear garden.

Kitchen/Dining Room

15'10" x 7'10" (4.83m x 2.39m)

Fitted with a good quality range of base and eye level units and working surfaces, incorporating a stainless steel single drainer sink unit with tiled splashbacks. With integrated stainless steel oven with four ring gas hob and stainless steel extractor over, integrated dishwasher and space for fridge/freezer. With wall mounted combination central heating and hot water boiler. Single radiator and two uPVC sealed unit double glazed windows to rear.

Garage/Workshop

28'9" x 7'0" (8.76m x 2.13m)

With a roller door, light and power and door to rear.

OUTSIDE

To the front of the property there is a block paved driveway suitable for the off road parking of a number of vehicles. The rear garden is manicured with flagged pathways and many mature flowerbeds with trees, shrubs, bushes and flowers etc. With outside patio seating area.

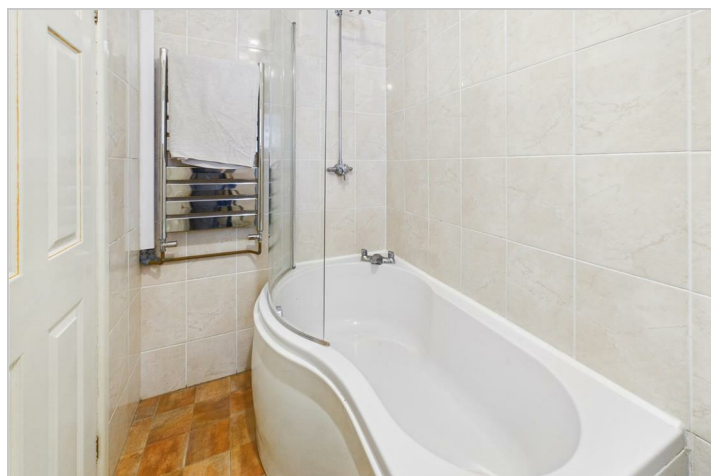

Road Map



Hybrid Map



Terrain Map



Floor Plans

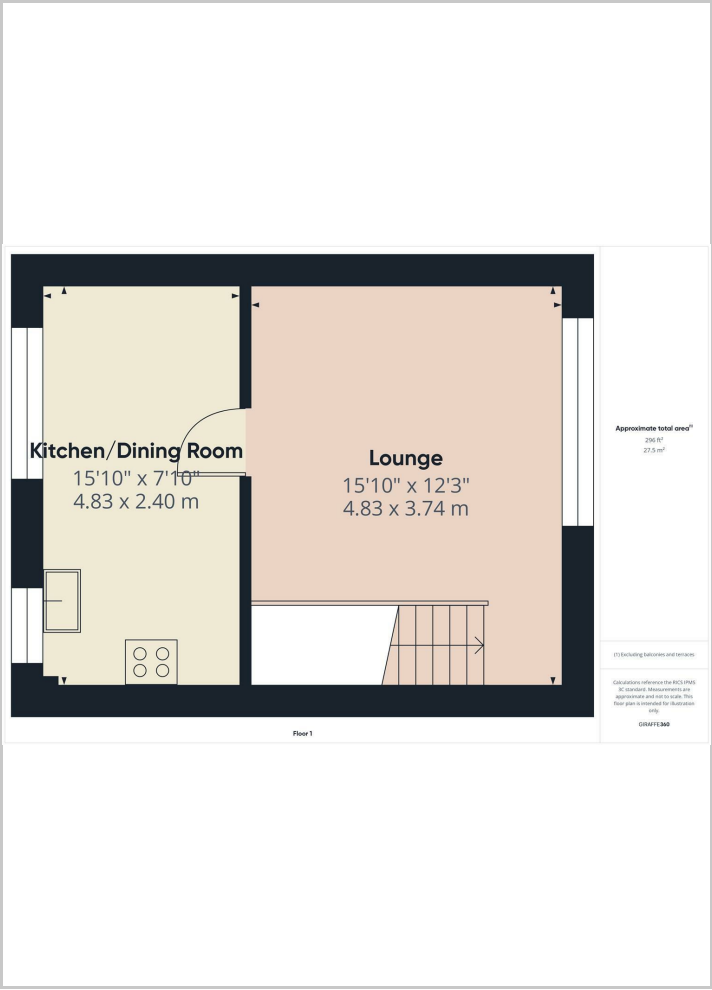
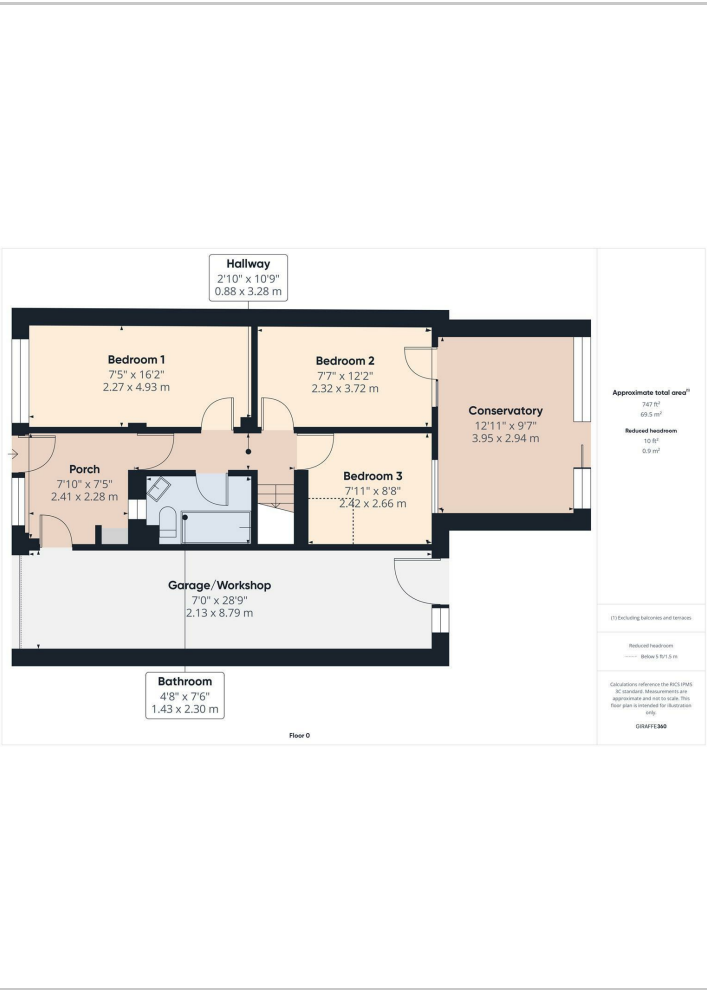

Viewing

Please contact our Mellors Estate Agents Office on 01298 24383 if you wish to arrange a viewing appointment for this property or require further information.

Important Notice
Mellors Estate Agents, their solicitors and joint agents give notice that:
1. They are not authorised to make or give any representations or warranties in relation to the property either here or elsewhere, either on their own behalf or on behalf of their client or otherwise. They assume no responsibility for any statement that may be made in these particulars. These particulars do not form part of any offer or contract and must not be relied upon as statements or representation of fact.
2. Any areas, measurements or distances are approximate. The text, photographs and plans are for guidance only and are not necessarily comprehensive. It should not be assumed that the property has all necessary planning building regulation or other consents and Mellors Estate Agents have not tested any services, equipment or facilities. Purchasers must satisfy themselves by inspection or otherwise.

1 Grove Parade, Buxton, Derbyshire, SK17 6AJ
Tel: 01298 24383 Email: info@mellors.org.uk www.mellors.org.uk

Energy Efficiency Graph

