



OFFERS IN THE REGION OF

£210,000

Don Terrace

Sheffield, S36 9QE

PROPERTY SUMMARY

Nestled in the highly desirable village of Thurlstone, this charming two-bedroom terraced home on Don Terrace has a stylish interior and presents an excellent opportunity for those seeking a peaceful yet well-connected lifestyle. Enjoying a unique tucked away position with access to the Pennine Trail nearby.

2



1



1









Approx Gross Internal Area
79 sq m / 850 sq ft

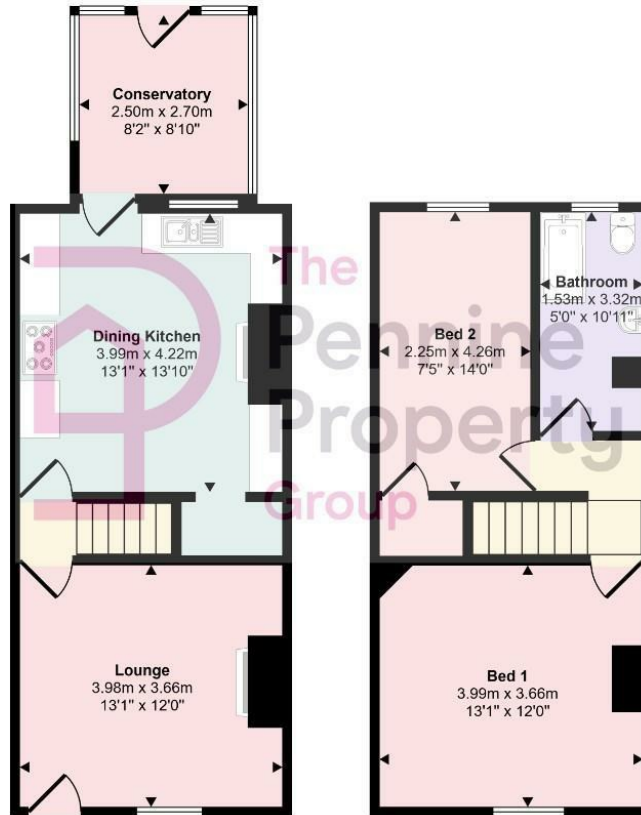

This floorplan is only for illustrative purposes and is not to scale. Measurements of rooms, doors, windows, and any items are approximate and no responsibility is taken for any error, omission or mis-statement. Icons of items such as bathroom suites are representations only and may not look like the real items. Made with Made Snappy 360.

LOCAL AUTHORITY

BMBC

TENURE

Freehold

COUNCIL TAX BAND

B

VIEWINGS

By prior appointment only

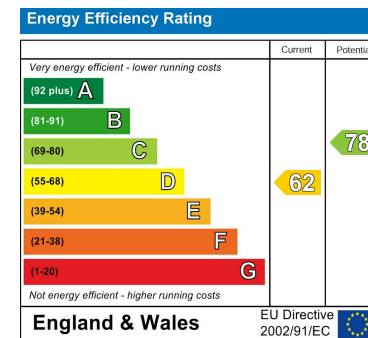

Agents Note: Whilst every care has been taken to prepare these particulars, they are for guidance purposes only. All measurements are approximate and are for general guidance purposes only and whilst every care has been taken to ensure their accuracy, they should not be relied upon and potential buyers/tenants are advised to recheck the measurements

OFFICE ADDRESS

12 St Marys Street
Penistone
Sheffield
South Yorkshire
S36 6DT

OFFICE DETAILS

01226 766755
info@pennineproperty.co.uk